

Installation Manual

A-2939 ARNOTT REAR AIR SPRING CITROEN PICASSO (C4)

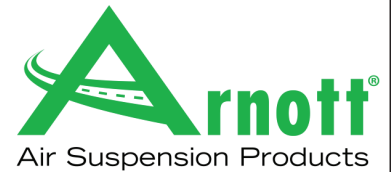

Congratulations on your purchase of an Arnett® air suspension product. We at Arnett Incorporated are proud to offer a high quality product at the industry's most competitive pricing. Thank you for your confidence in us and our product.

Proper installation is essential to experience and appreciate the benefits of this system. Please take a moment to review these installation instructions before you begin to install these components on your vehicle. The removal and installation of air suspension products should only be performed by a fully qualified, ASE Certified, professional.

It is equally important to be aware of all necessary safety measures while installing your new Air Suspension System. This includes proper lifting and immobilizing of the vehicle and isolation of any stored energy to prevent personal injury or property damage.

"Engineered to Ride, Built to Last®"



WARNING: *The air suspension system is under pressure (up to 10 bar, or 150 lbf/in). Verify pressure has been relieved and disconnect power to the air suspension system prior to disassembly. Do not allow dirt or grease to enter the system. Always wear standard hand, ear, and eye protection when servicing the air suspension system.*

Arnett® is committed to the quality of its products. If you have a question or problem with any Arnett product, please contact Arnett by calling **800-251-8993** during normal business hours or email techassistance@arnottinc.com. (In the EU please call +31 (0)73 7850 580 or email info@arnotteurope.com)

GENERAL INFORMATION:

Reading this manual signifies your agreement to the terms of the general release, waiver of liability, and hold harmless agreement, the full text of which is available at www.arnottinc.com.

- Not to be stored below 5°F (-15°C) or above 122°F (50°C).
- Avoid damage to air lines and cables.
- Removal and installation is only to be performed by fully qualified personnel.
- Use car manufacturer's diagnostic software.

CAUTION: *Damage to the vehicle and air suspension system can be incurred if work is carried out in a manner other than specified in the instructions or in a different sequence.*



To avoid the possibility of short circuits while working with electric components consult your owner's manual on how to disconnect your battery.



Consult your vehicle owner's manual, service manual, or car dealer for the correct jacking points on your vehicle and for additional care, safety and maintenance instructions. Under no circumstances should any work be completed underneath the vehicle if it is not adequately supported, as serious injuries and death can occur.

AIR SPRING REMOVAL

1. RAISE THE VEHICLE.
2. REMOVE THE APPLICABLE REAR WHEEL, AS NEEDED FOR ACCESS.
3. LOCATE AND REMOVE THE COMPRESSOR PROTECTIVE COVER.
4. LOCATE AND REMOVE THE AIR LINE CONNECTION AT THE VEHICLES COMPRESSOR ASSEMBLY TO DEFLATE THE APPLICABLE AIR SPRING. (FIGURE 1)

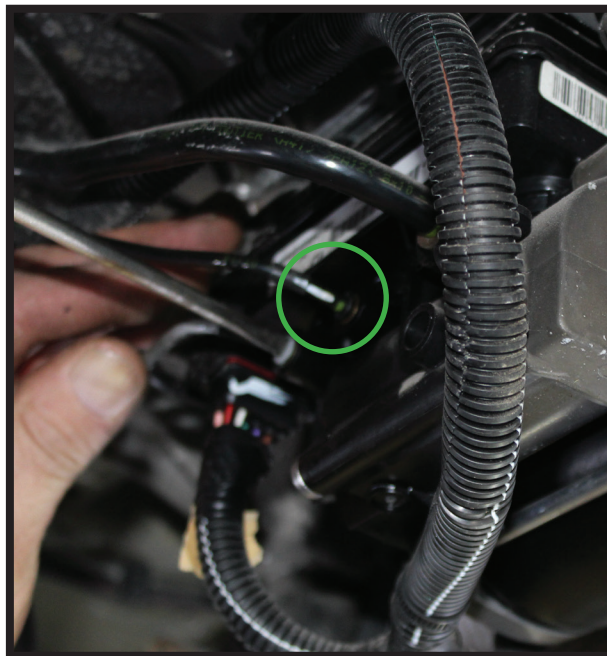

FIGURE 1

5. LOCATE THE AIR SPRING. (FIGURE 3)



FIGURE 3

6. DISCONNECT THE AIR LINE BY PUSHING INWARD ON THE CONNECTOR SURROUNDING THE HOSE WHILE SIMULTANEOUSLY PULLING THE HOSE OUTWARD. (FIGURES 4, 5)



FIGURE 4



FIGURE 5

7. REMOVAL COMPLETE.

AIR SPRING INSTALLATION



Tighten all nuts and bolts to manufacturer's specifications during the installation process.

1. OBTAIN THE NEW ARNOTT SPRING. (FIGURE 6)



FIGURE 6

2. CONNECT THE AIR LINE AT THE TOP OF THE AIR SPRING, AS PER THE FOLLOWING SUB-STEPS. (FIGURE 7)



FIGURE 7

INSTALLATION

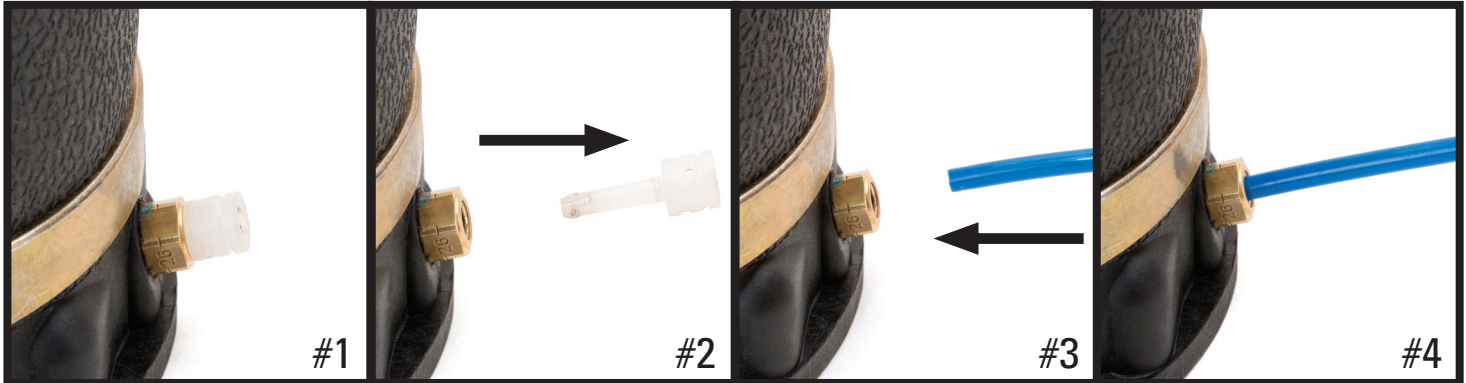

AS RECEIVED

REMOVE & DISPOSE OF
SHIPPING PIN

INSERT THE AIR LINE INTO
THE FITTING AND PRESS
UNTIL FIRMLY SEATED

WITH THE AIR LINE INSERTED,
PULL AIR LINE OUTWARD TO
LOCK AND ENSURE A SECURE
CONNECTION

3. RAISE THE REAR AXLE OR REINSTALL THE TIRE AND LOWER THE VEHICLE.
ENSURE THE AIR SPRING IS PROPERLY SEATED PRIOR TO INFLATING. (FIGURE 8)



FIGURE 8

4. REATTACH AIR LINE TO COMPRESSOR ASSEMBLY AND REINSTALL PROTECTIVE COVER.
(FIGURE 9)

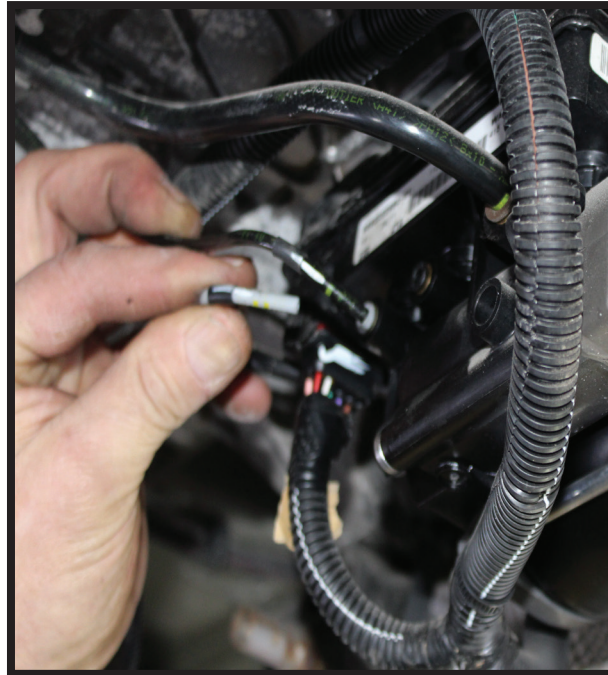

FIGURE 9

5. INSTALLATION COMPLETE.